

ENGINEERING GRAPHICS AND DESIGN

INGENIEURSGRAFIKA EN -ONTWERP

PAPER 1

VRAESTEL 1

MEMORANDUM

GR 11

NOVEMBER 2013

This memorandum consists of 6 pages.

Hierdie memorandum bestaan uit 6 bladsye.

20

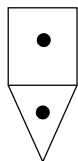

● FREEHAND
VRYHAND
(3)

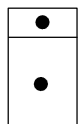

● FREEHAND
VRYHAND
(3)

	ANSWERS			ANTWOORDE		
1	00341	1	1	00341	1	
2	NEW SHOWER IN BATHROOM	1	2	NUWE STORT IN BADKAMER	1	
3	P QABAZI	1	3	P QABAZI	1	
4	PORT ELIZABETH	1	4	PORT ELIZABETH	1	
5	G ZAMO	1	5	G ZAMO	1	
6	1:100	1	6	1:100	1	
7	05-07-2013	1	7	05-07-2013	1	
8	FINISHED FLOOR LEVEL	1	8	VOLTOOIDE VLOERVLAK	1	
9	BUILT IN CUPBOARD	1	9	INGEBOUDE KAS	1	
10	WC	1	10	WC	1	
11	NORTH DIRECTION / TRUE NORTH	1	11	NOORDELIKE RIGTING	1	
12	SOUTH ELEVATION	1	12	SUIDAANSIG	1	
13	FLOOR PLAN	1	13	VLOERPLAN	1	
14	TILES	1	14	TEËLS	1	
15	PLASTER AND PAINT	1	15	PLEISTER EN VERF	1	
16	THREE	1	16	DRIE	1	
17	$(12000 \times 2) + (13000 \times 2)$ $= 24000 + 26000$ $= 50 \text{ metres}$	4	17	$(12000 \times 2) + (13000 \times 2)$ $= 24000 + 26000$ $= 50 \text{ meters}$	4	
18	$(13 \times 7) + (5 \times 7,5)$ $= 91 + 37,5$ $= 128,5 \text{ m}^2$	4	18	$(13 \times 7) + (5 \times 7,5)$ $= 91 + 37,5$ $= 128,5 \text{ m}^2$	4	
19		6	19		6	
	TOTAL	30		TOTAAL	30	

MEMORANDUM

Copyright reserved

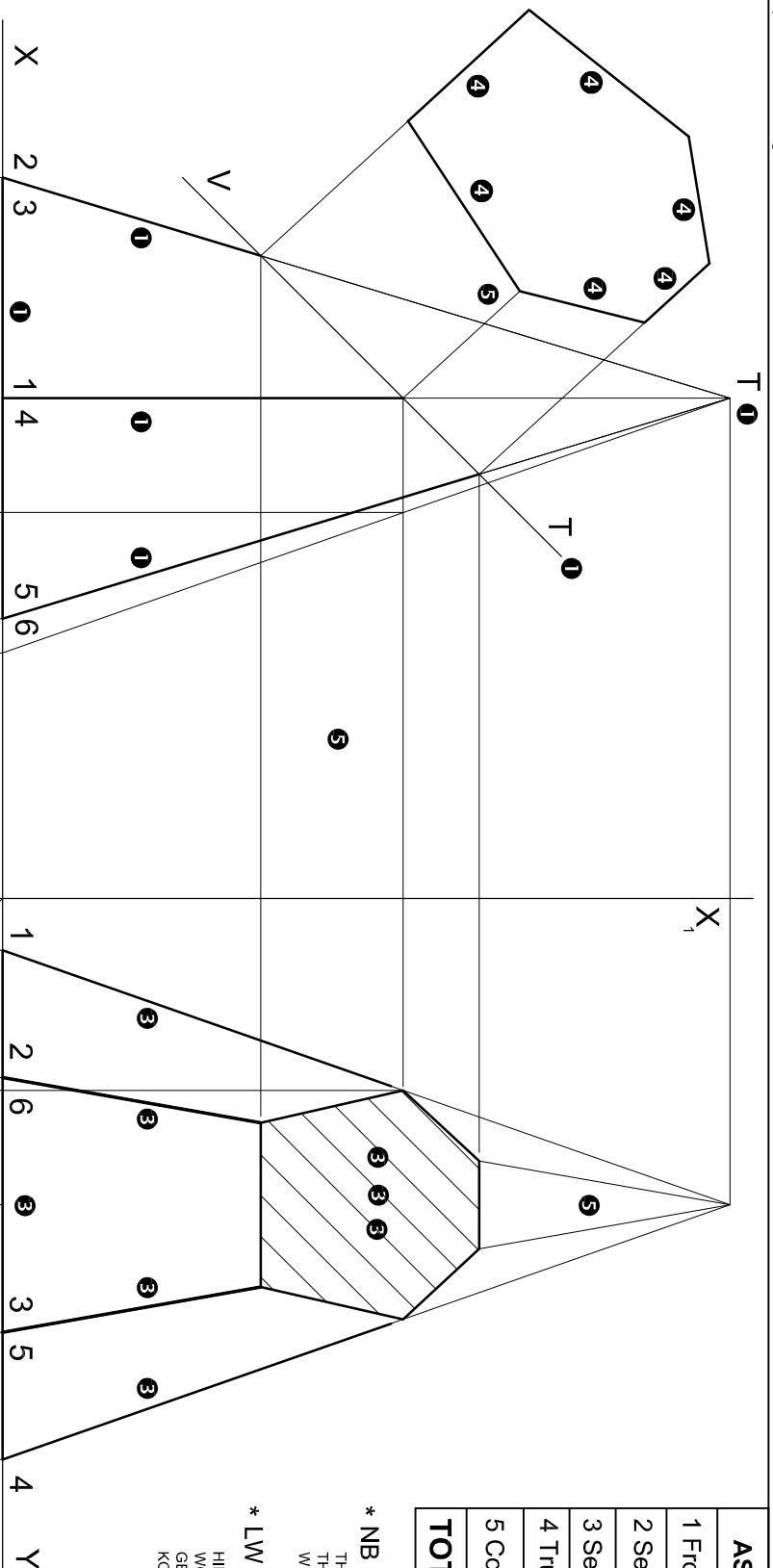

ASSESSMENT CRITERIA	
1 Front view	6
2 Sectional top view	9
3 Sectional left view	8
4 True shape	6
5 Constructions	6
TOTAL	35

*** NB**
 THESE TWO MARKS MAY BE GIVEN IF
 THE SECTION IS DRAWN CORRECTLY
 WITHOUT THESE CONSTRUCTIONS.

*** LW**
 HIERDIE TWEE PUNTE MAG TOEGEKEN
 WORD INDIEN DIE SITT KORREK
 GETEKEN IS SONDER HIERDIE
 KONSTRUKSIES.

ASSESSERINGSKRITERIA	
1 Vooransig	6
2 Deursnee-boansig	9
3 Deursnee-linkeraansig	8
4 Ware vorm	6
5 Konstruksies	6
TOTAL	35

PAPER 1 QUESTION 2
 GR 11 NOVEMBER 2013

MEMORANDUM

ASSESSERINGSKRITERIA	
1 Verdwynpunte	4
2 Konstruksies	4
3 Dakke	10
4 Mure	18
TOTAL	36

ASSESSMENT CRITERIA	
1 Vanishing points	4
2 Constructions	4
3 Roofs	10
4 Walls	18
TOTAL	36

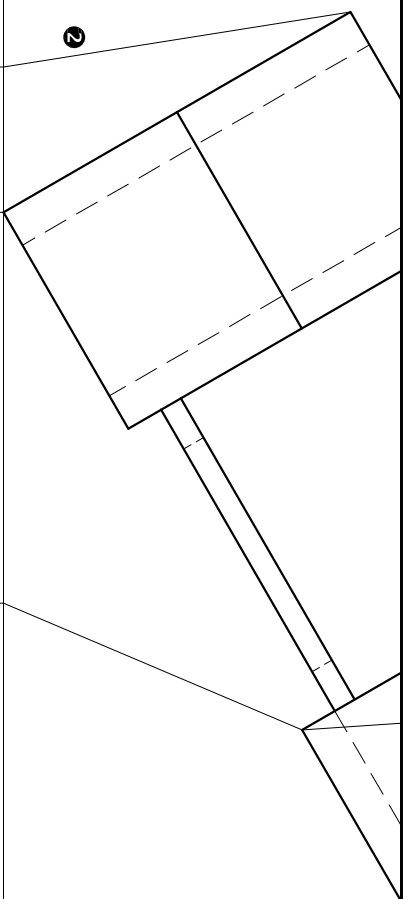

PV PP

	2	
00 LVP		00 RVP

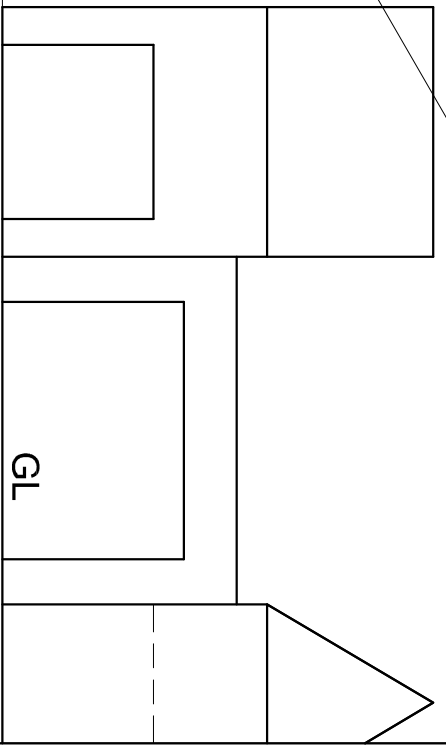
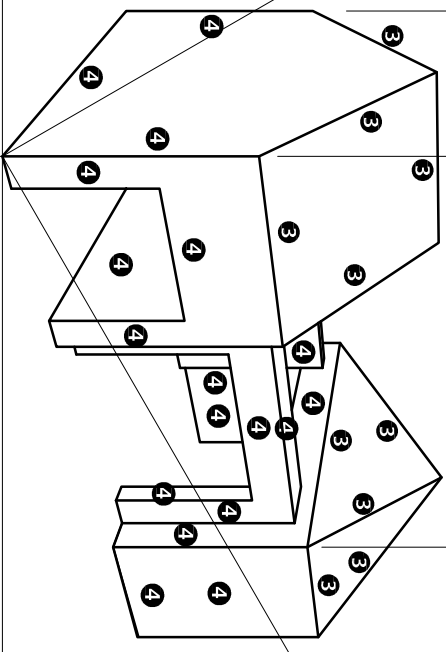
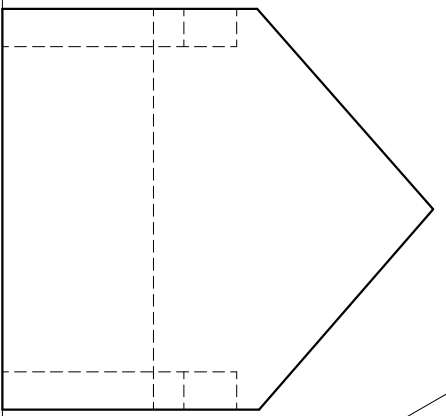

SP

HL

VRAESTEL 1 VRAAG 4
GR 11 NOVEMBER 2013

PAPER 1 QUESTION 4
GR 11 NOVEMBER 2013

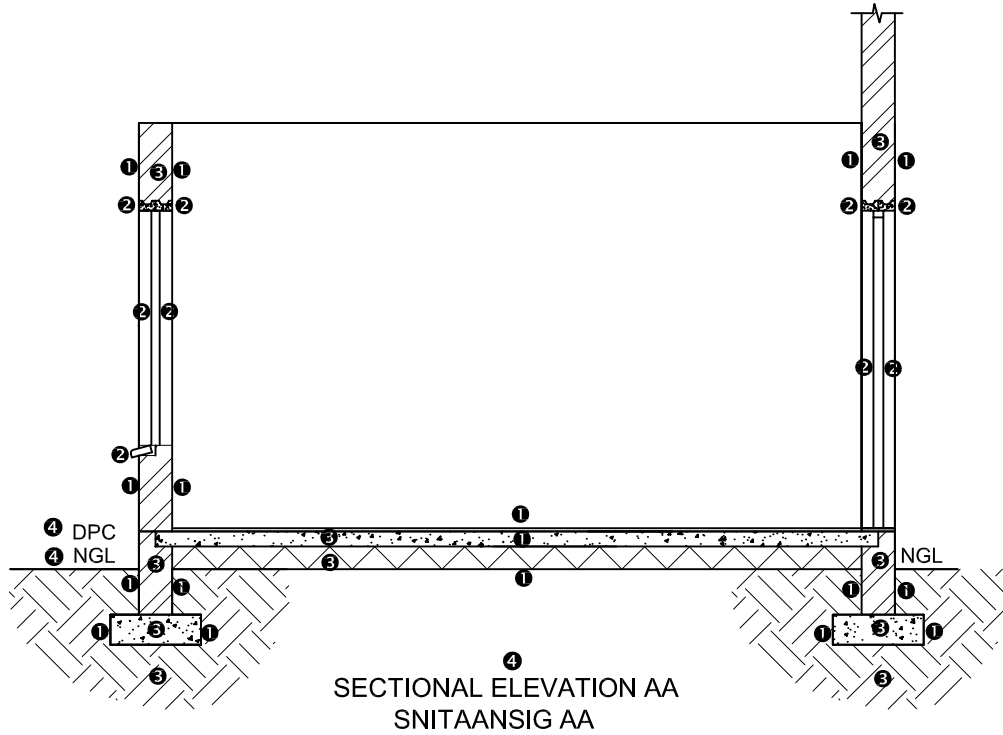

SECTIONAL ELEVATION AA
SNITAANSIG AA

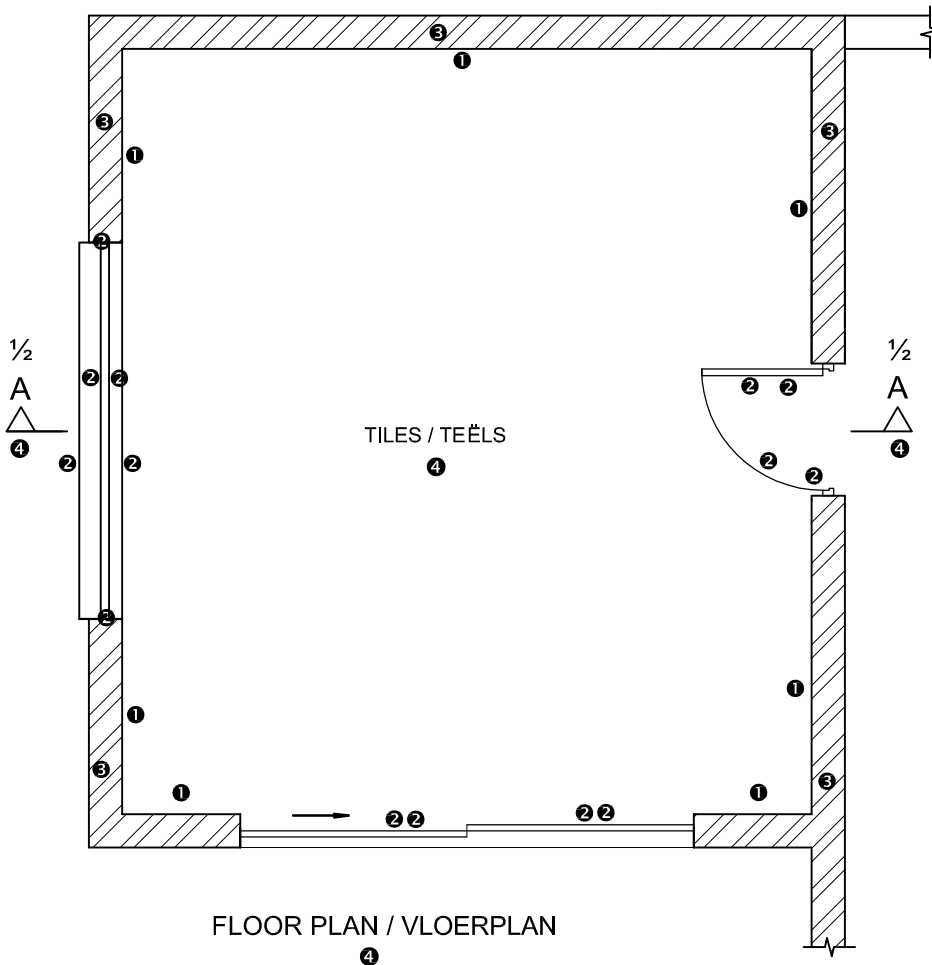

FLOOR PLAN / VLOERPLAN

SECTIONAL ELEVATION	
1 FOUNDATION AND WALLS	17
2 WINDOW, DOOR AND LINTELS	9
3 HATCHING	10
4 LABELS	3
SUB TOTAL	39
SNITAANSIG	
1 FONDASIE EN MURE	17
2 VENSTER, DEUR EN LATEIE	9
3 ARSERING	10
4 BYSKRIFTE	3
SUBTOTAAL	39
FLOOR PLAN	
1 WALLS	7
2 DOORS & WINDOW	14
3 SECTIONING	5
4 LABELS AND C/PLANE	5
SUB TOTAL	31
VLOERPLAN	
1 MURE	7
2 DEURE EN VENSTER	14
3 ARSERING	5
4 BYSKRIFTE EN S/VLAK	5
SUBTOTAAL	31

NB
MEMORANDUM
CONTINUES ON PG 6

MEMORANDUM

Copyright reserved

LW
MEMORANDUM VOLG
AAN OP BL 6

VRAESTEL 1 VRAAG 4
GR 11 NOVEMBER 2013

PAPER 1 QUESTION 4
GR 11 NOVEMBER 2013

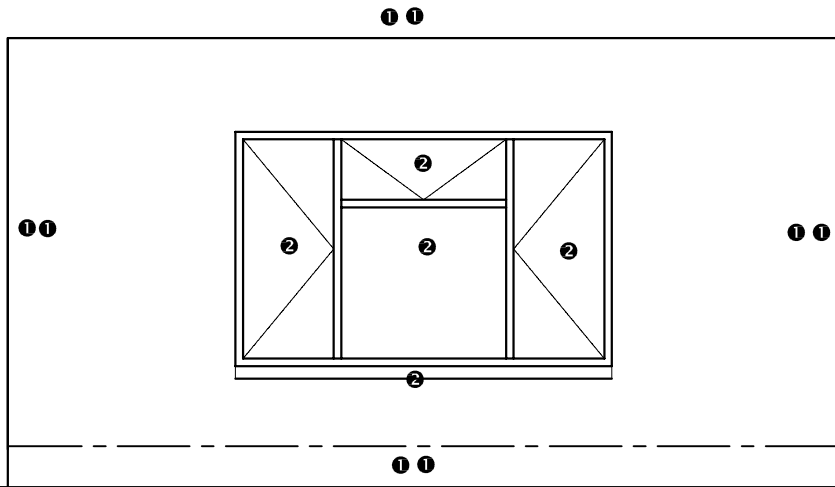

WEST ELEVATION / WESAANSIG
3 3

WEST ELEVATION	
1 EXTERNAL WALLS AND CEILING	8
2 WINDOW	5
3 LABEL	2
SUB TOTAL	15
WESAANSIG	
1 BUITEMURE EN PLAFON	8
2 VENSTER	5
3 BYSKRIF	2
SUBTOTAAL	15

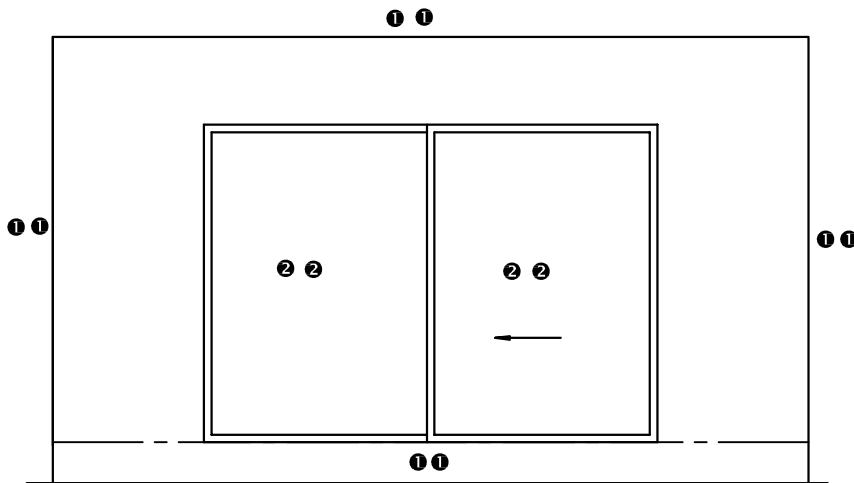

SOUTH ELEVATION / SUIDAANSIG
3 3

SOUTH ELEVATION	
1 EXTERIOR WALLS AND CEILING	8
2 SLIDING DOOR	4
3 LABEL	2
SUB TOTAL	14
SUIDAANSIG	
1 BUITEMURE EN PLAFON	8
2 GLYDEUR	4
3 BYSKRIF	2
SUBTOTAAL	14
TOTAAL / TOTAL	99

MEMORANDUM